

**NOTES**

1. ALL WELDING SHALL BE TO THE REQUIREMENTS OF AS/NZS 1554.1 AND NZS 3404
2. ALL WELDS NOT SHOWN OTHERWISE TO BE THE THICKNESS OF THE PLATE WITH A MINIMUM OF 6mm SP FILLET
3. ALL WELDS TO BE CATEGORY SP
4. STEEL GRADES SHALL BE AS FOLLOWS:  

PLATE (EXCEPT BASE PLATE)	GRADE 250
BASE PLATE AND ANGLES	GRADE 300
CHS TUBE	GRADE 250
5. ALL STEEL TO BE HOT DIP GALVANISED TO AS/NZS 4680
6. ALL BOLTS TO BE GRADE 8.8 SNUG TIGHT UNLESS NOTED OTHERWISE
7. SINGLE NUT BOLTS (EXCEPT HSG ASSEMBLIES) TO HAVE LOCKING NUT OR SPRING WASHER
8. DESIGN PARAMETERS TO AS/NZS 1170
9. SWING WING POLES ARE DESIGNED TO A SPECIFIED MOUNTING HEIGHT AND LIGHTING REQUIREMENTS. EACH POLE IS COUNTERBALANCED FOR SPECIFIED LIGHTS. PLEASE CONTACT SPUNLITE FOR MORE INFORMATION.
10. MINIMUM ULTIMATE SOIL BEARING PRESSURE SHALL BE 100KPA AND ULTIMATE SHEAR CAPACITY 40KPA. FOUNDATION DESIGN IS TO BE COMPLETED BY A CHARTERED PROFESSIONAL ENGINEER BASED ON SITE SPECIFIC GEOTECHNICAL ASSESSMENT.
11. FOUNDATION DESIGN INFORMATION IS SUPPLIED AS A GUIDE ONLY. OTHER SOLUTIONS MAY BE MORE APPROPRIATE FOR SPECIFIC SITUATIONS. DUE TO VARIATIONS IN SITE CONDITIONS AND INSTALLATION PROCEDURES, SPUNLITE DOES NOT ACCEPT LEGAL LIABILITY FOR THE USE OF THIS INFORMATION.

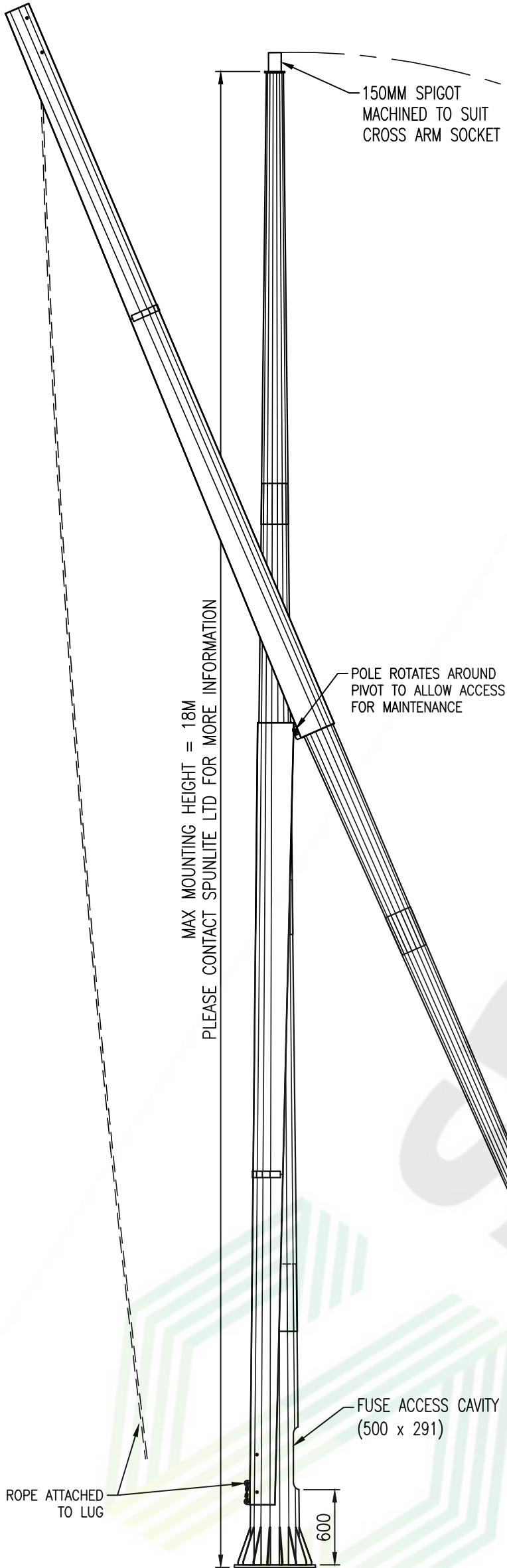

COMPLETE ASSEMBLED VIEW  
SCALE 1:40

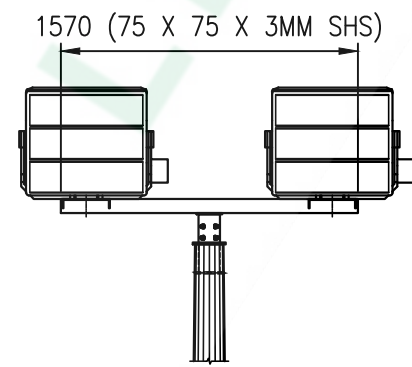

EXAMPLE POLE TOP CROSS ARM – ELEVATION VIEW  
TYP LUMINAIRE SHOWN  
SCALE (1:40)

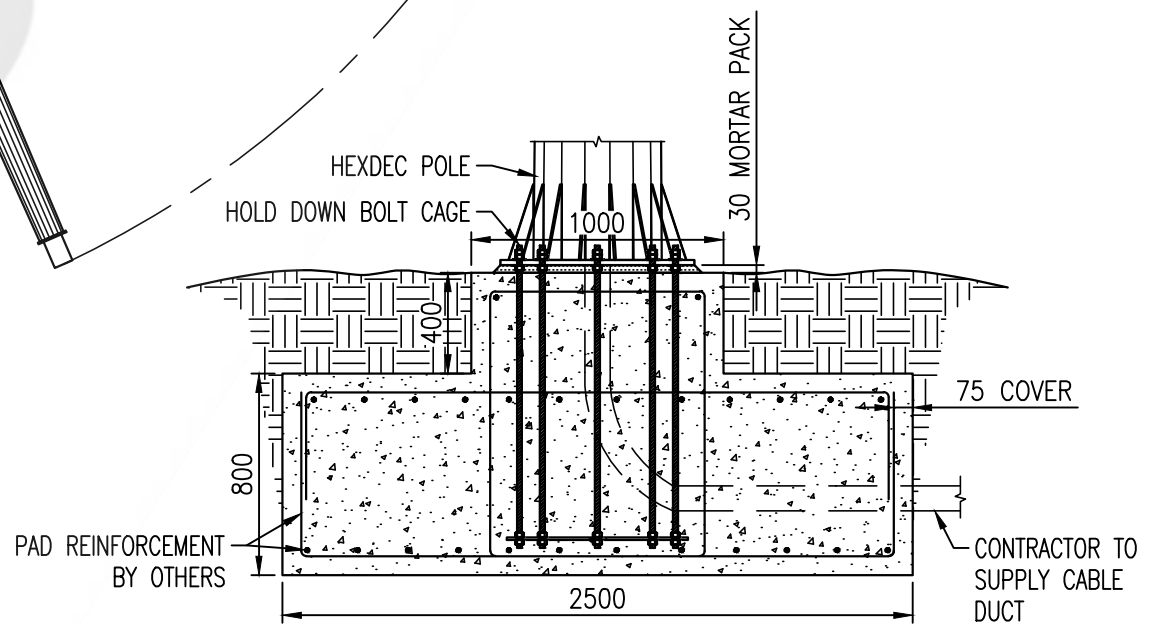

EXAMPLE FOUNDATION DESIGN ONLY – SEE NOTE 11  
NOT FOR CONSTRUCTION – ALL DIMENSIONS NOMINAL  
SPECIFIC FOUNDATION DESIGNS DESIGNED UPON REQUEST

Rev	Amendment Description	By	Chk	Date	DESIGN PARAMETERS:
1	FIRST PRODUCTION ISSUE	SG		08.10.20	Design Working Life: 50 Importance Level: 2 Wind Region: A Terrain Category: 2 Site Elevation: <350m
					PRODUCT NUMBER
					—
					SHEET
					C1
					SHT 01/01
					DRG.SIZE
					A3
					SCALE
					AS SHOWN
					REVISION
					1



PRODUCT: SWING WING RANGE  
TITLE: SWING WING FLANGE BASED POLE