

Drill a 10mm dia hole in top face ONLY 20mm from end. (for clients Earth)

Drill 18mm dia hole through pipe 45mm from end - note orientation.

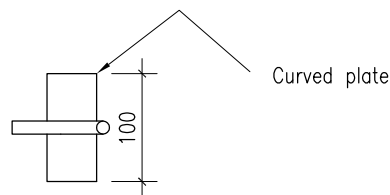

Curved plate

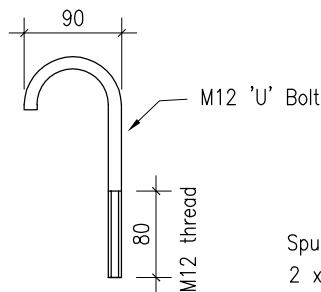

M12 'U' Bolt

- Spunlite to supply with:-
 2 x M12 Nuts (Galv)
 2 x M12 Flat Washers (Galv)
 1 x M12 Spring Washers (Galv)



611 Halswell Junction Rd, Hornby, Christchurch, NZ
 ph(03)349-7853 fax(03)349-6529 freeph(0800)845-845
 i.net www.spunlite.co.nz

Project: -

Address: -

Title: S19 Outreach complete with 'J' Bolt.

Spun Lite Poles Ltd claim authorship of this work & retain intellectual & artistic copyright

scale: 1:40

file: Library

date: 16.5.08

drawn: dgw

sheet:

C1

revision: C